

Welcome!

What's this event all about?

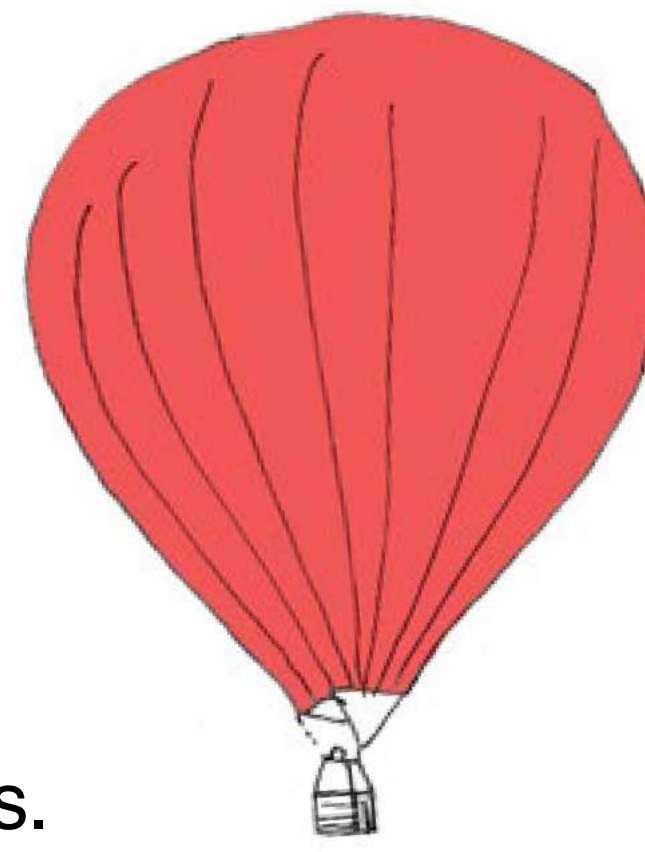

Beckton Parks Masterplan is one of London's most ambitious urban green space projects. Co-designed with local communities, it sets out a vision for investment and improvement in 36 hectares of Newham parkland to support wellbeing and activity.

Architects East, who drew up the Masterplan, are now working on early projects in key locations to address community priorities around safer routes and better play, sports and leisure.

At today's event you can:

- Get up to date on Beckton Parks Masterplan progress
- Find out about works getting underway to improve Beckton Corridor
- Share your thoughts on emerging plans for sports, play and leisure around Will Thorne Pavilion

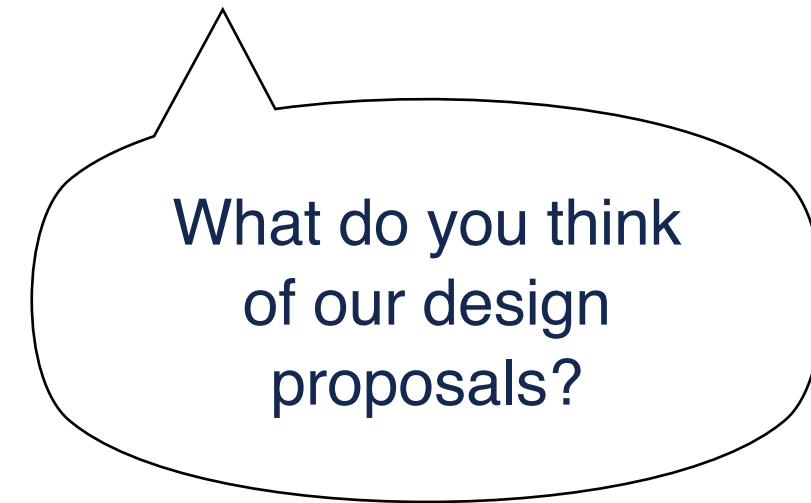

What are the projects we're showing you?



Beckton Sports & Play Vision - Masterplan

Sports and Leisure Hub

East Architects are working with Newham's Parks Service to develop designs for the Sports and Leisure Hub outside Will Thorne Pavilion, which is currently being refurbished. Designs will include new urban play, a 'PlayZone' MUGA, informal sports and recreation areas and a new lit pathway with seating, in line with the Masterplan's Community Vision for the area.



Works have begun on Beckton Corridor

Beckton Corridor

East are also working with Newham's Highways and Parks Services to design entrances and special features for the Beckton Corridor walking and cycling route, which is currently being widened and resurfaced. The designs will draw on principles set out in the masterplan and on the design of the entrance to the Queen Elizabeth Memorial Pathway in Beckton Meadows, which was opened earlier this year.

How to share your thoughts ...

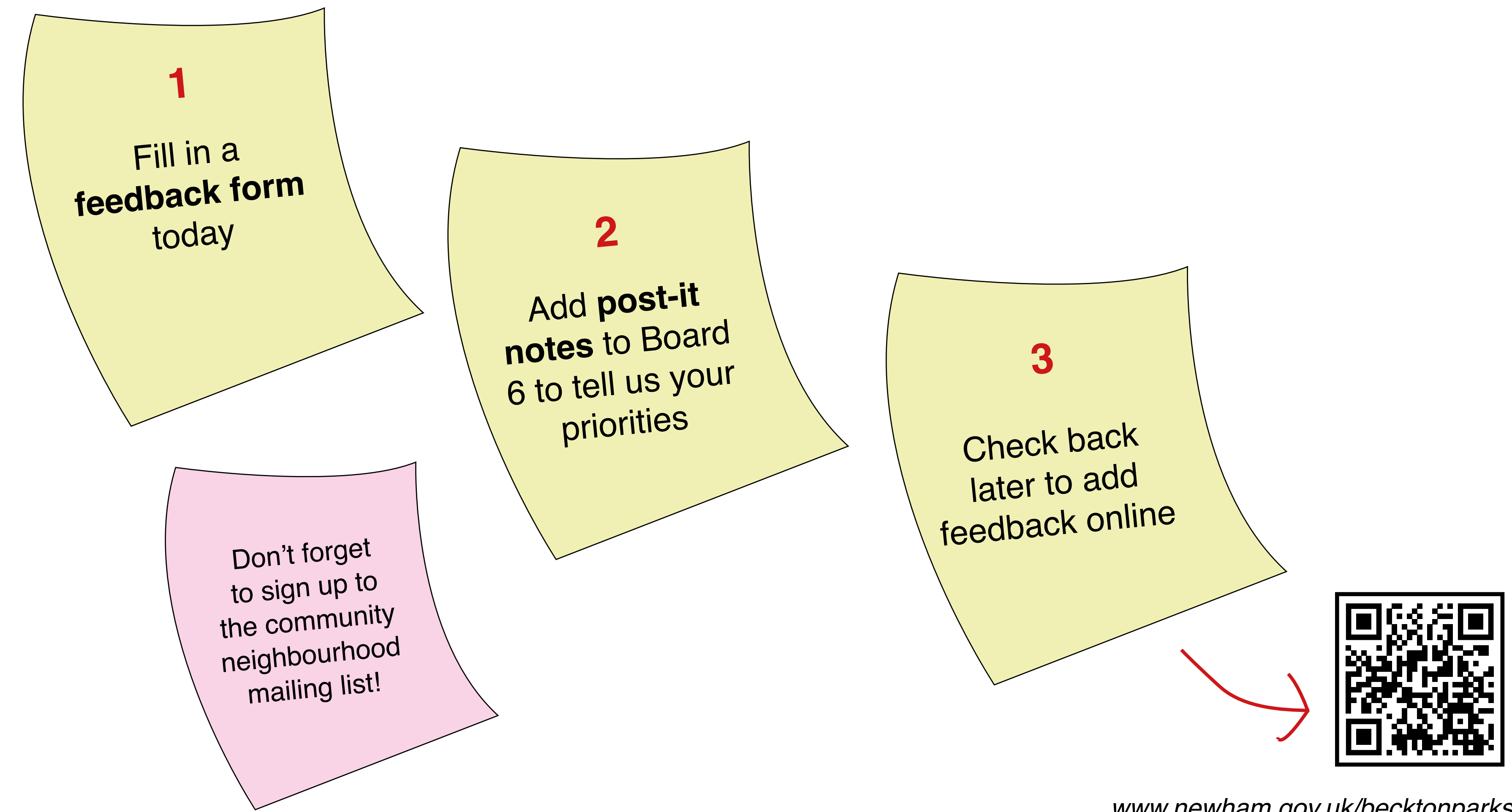

www.newham.gov.uk/becktonparks

What's happening when?

Sports and Leisure Hub Timeline



We are here!

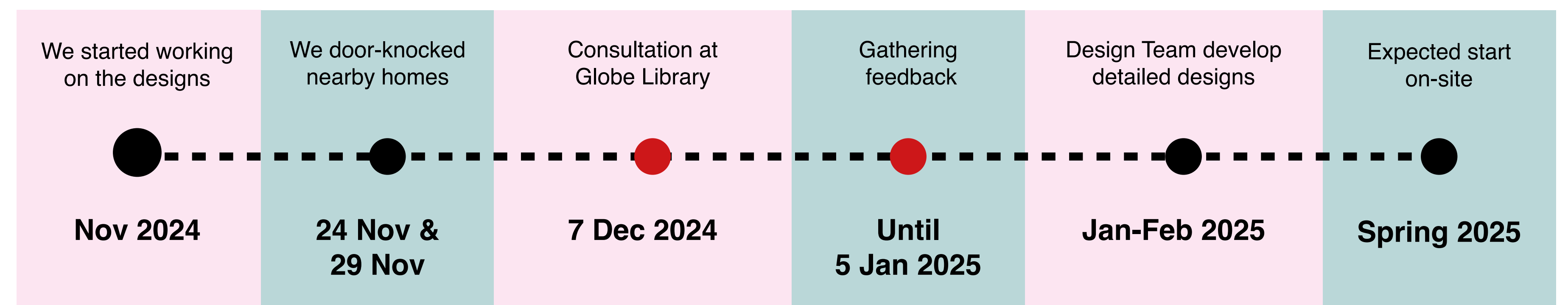

Beckton Corridor Timeline

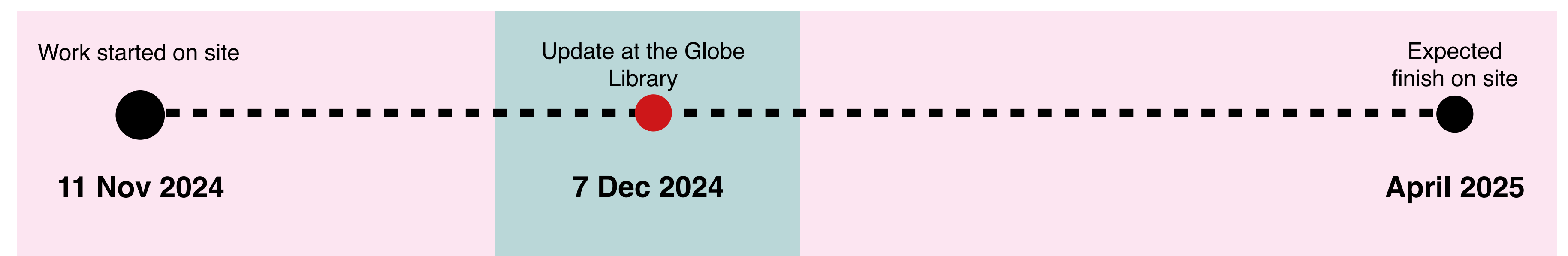

Beckton Parks Masterplan Update

The Community Vision

The Masterplan was co-designed with local residents and community groups over 2022-2023 through workshops, drop-ins, conversations and on-site activity. Newham Council's Cabinet adopted the Masterplan in January 2024.

Since then a number of projects have already been completed and others are underway.

To read more about the Beckton Parks Masterplan and the Community Vision, scan the QR code below or visit www.newham.gov.uk/becktonparks



Ecological improvements to Beckton Lake and the surrounding park

Works are underway

Will Thorne Pavilion cafe and toilet facilities

Coming soon!

Sports and Leisure

Queen Elizabeth Memorial Pathway

Delivered in 2024.

Beckton Corridor

Under way!

Butterfly Garden

Delivered in 2024.

Deadwood Sculpture

Delivered in 2024.

ROYAL ALBERT

Beckton Meadows

Delivered in 2024.

New Park Entrance

Delivered in 2024.

Play on the way at Queen Elizabeth Memorial pathway

Delivered in 2024.

Beckton Corridor

Beckton Corridor is an important pedestrian route, separated from car traffic, connecting Beckton DLR to residential areas, Beckton Park and Royal Albert Way.

A clear vision for the safe, attractive Corridor was set out in the Masterplan. This is now being brought to life.

What's happening?

- Segregated walking and cycling surfaces along a widened path - Newham Council consulted on different options for this at the end of 2023 to identify the best solution.
- Improved entrances, highlighting the unique and special character of the Corridor
- Updated lighting and CCTV
- Play-on-the-way areas along the route to allow children to enjoy travelling along the corridor.
- Outdoor fitness trail as proposed by residents during the development of the masterplan



Archway signage at entrance from Asda/Bus Station and from DLR

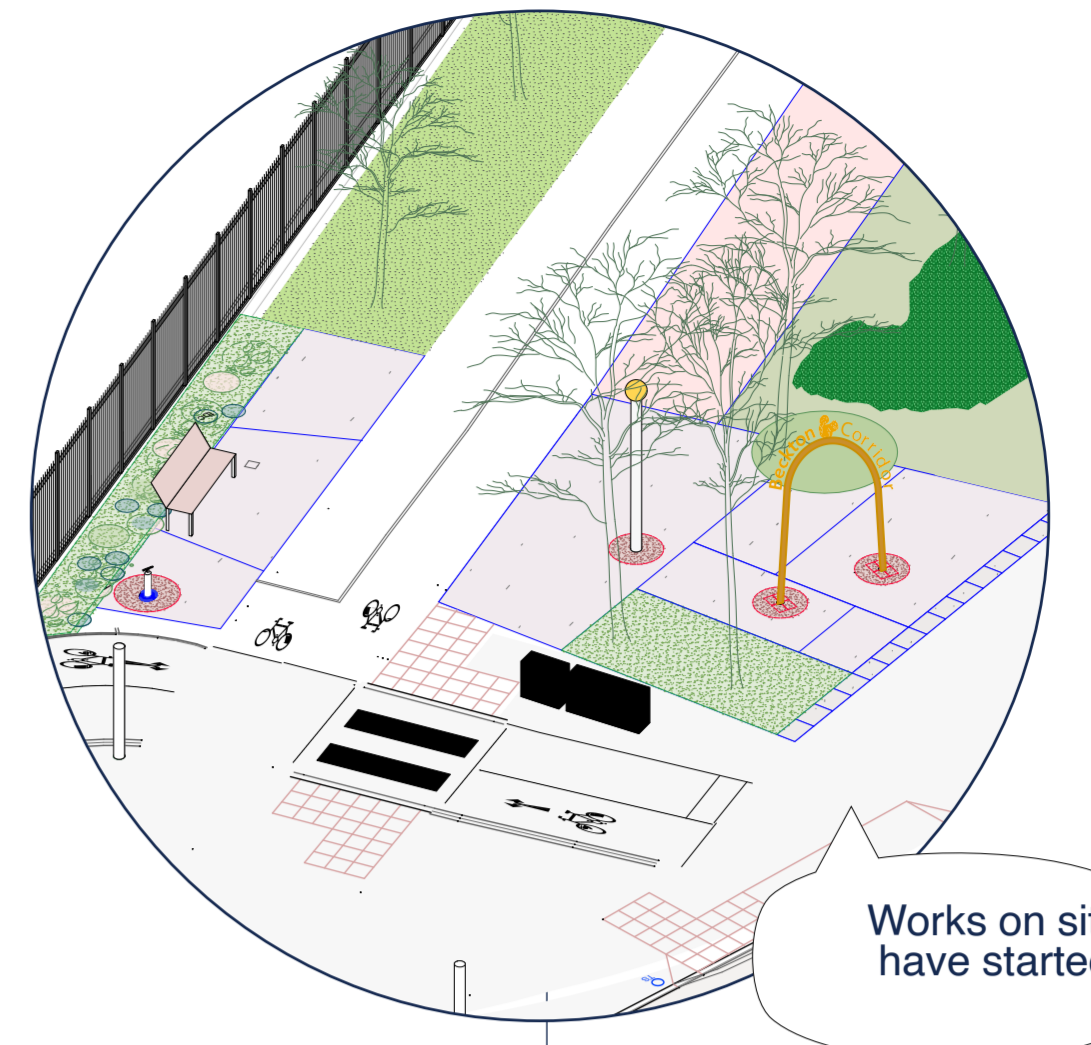

Special entry to the Corridor opposite the DLR

Works on site have started



Delivery in 2025

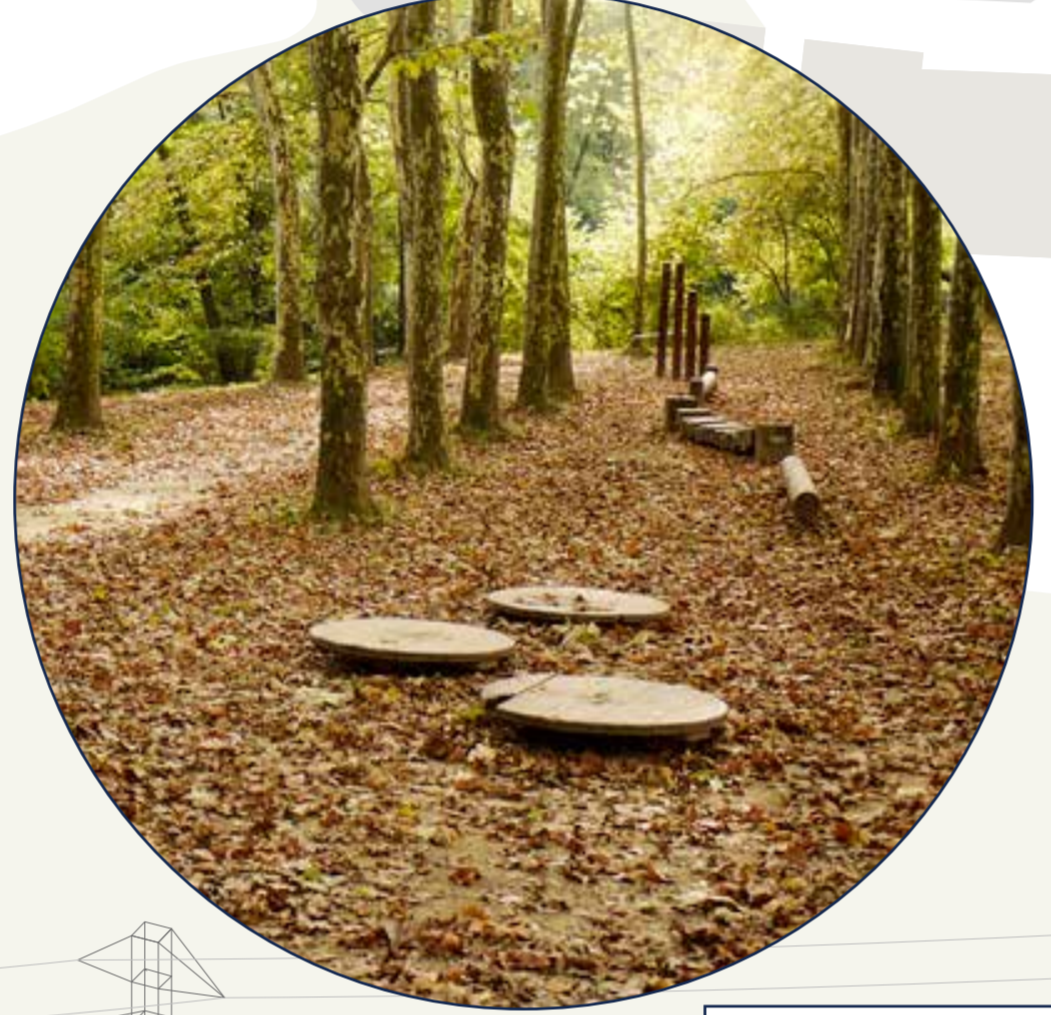

Play-on-the way along the corridor



New Fitness Trail to Northern side of Beckton Corridor

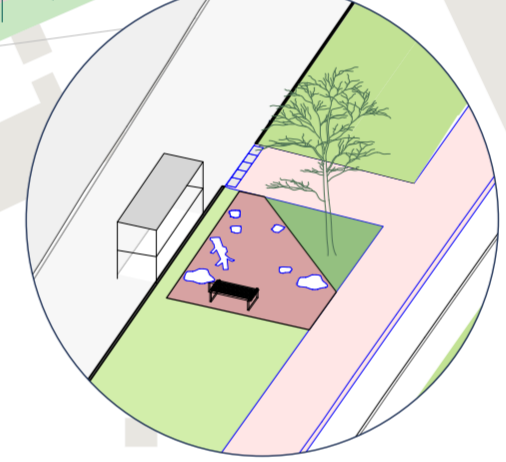

Improved entrances and play on the way



Bench at the entrance to stop and rest

Careful clearance of Ivy and shrubs along the corridor, increasing its width



Works have begun!



New signage and remedial works to historic turning circles

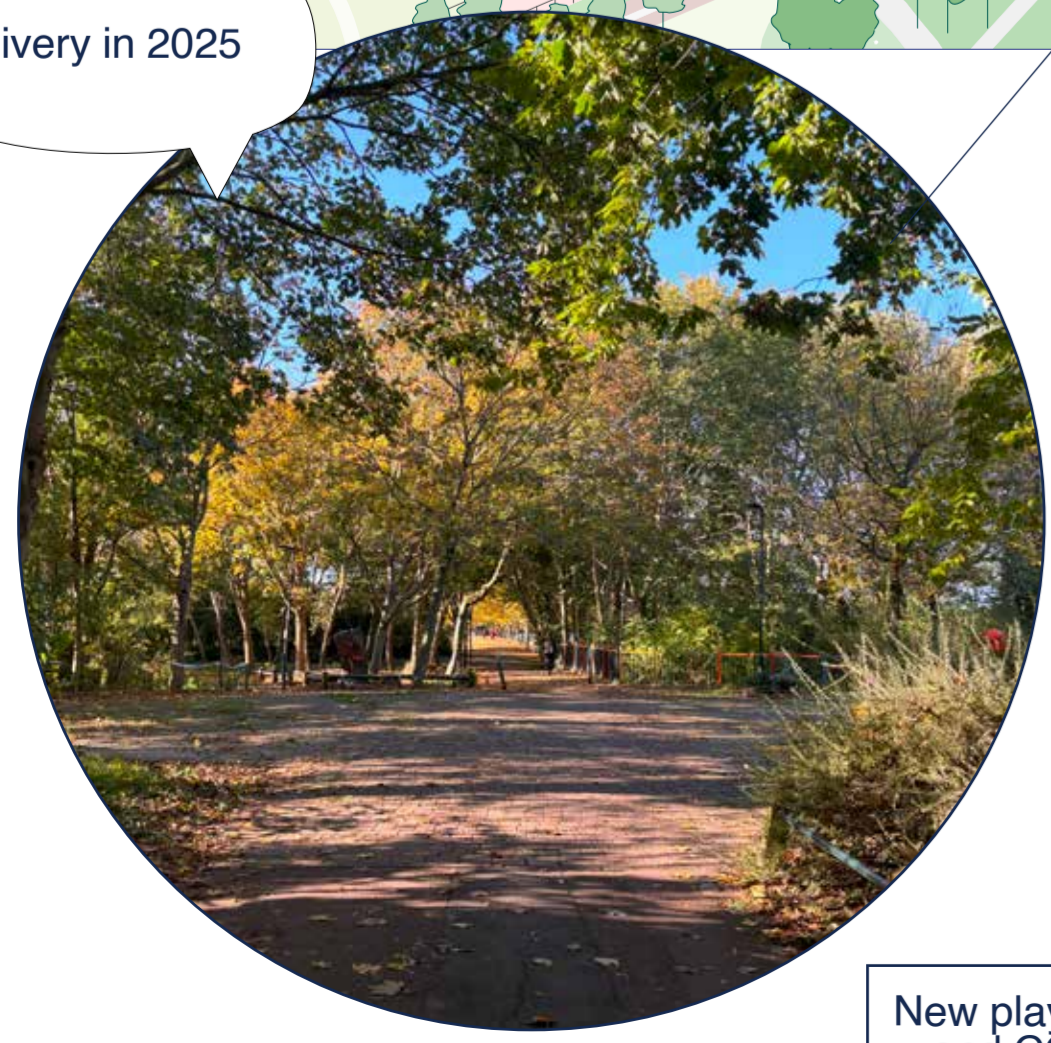

New play area, seating and CCTV at Pond



New information boards will help inform and allow for orientation

The Starting Point for Designs

Co-design workshops in 2022 led to a **Vision for a Sport and Active Leisure Hub around Will Thorne Pavilion** and in the green areas in front of it.

Our task now is to turn that Vision into Detailed Plans. While some aspects may need to adapt in response to new information, resident feedback, available funding etc. It's vital that we stay true to the Vision and to agreed community priorities.

Key:		
■ Wheeled sports	■ Swimming	■ Food growing
■ Skate park	■ Tennis	■ Events
■ Running track	■ Cricket	■ Dog park
■ Outdoor exercise	■ Inclusive playground	
■ Multi Use Games Area	■ Natural play and play-on-the-way	
■ Informal sports	■ Improved existing play	

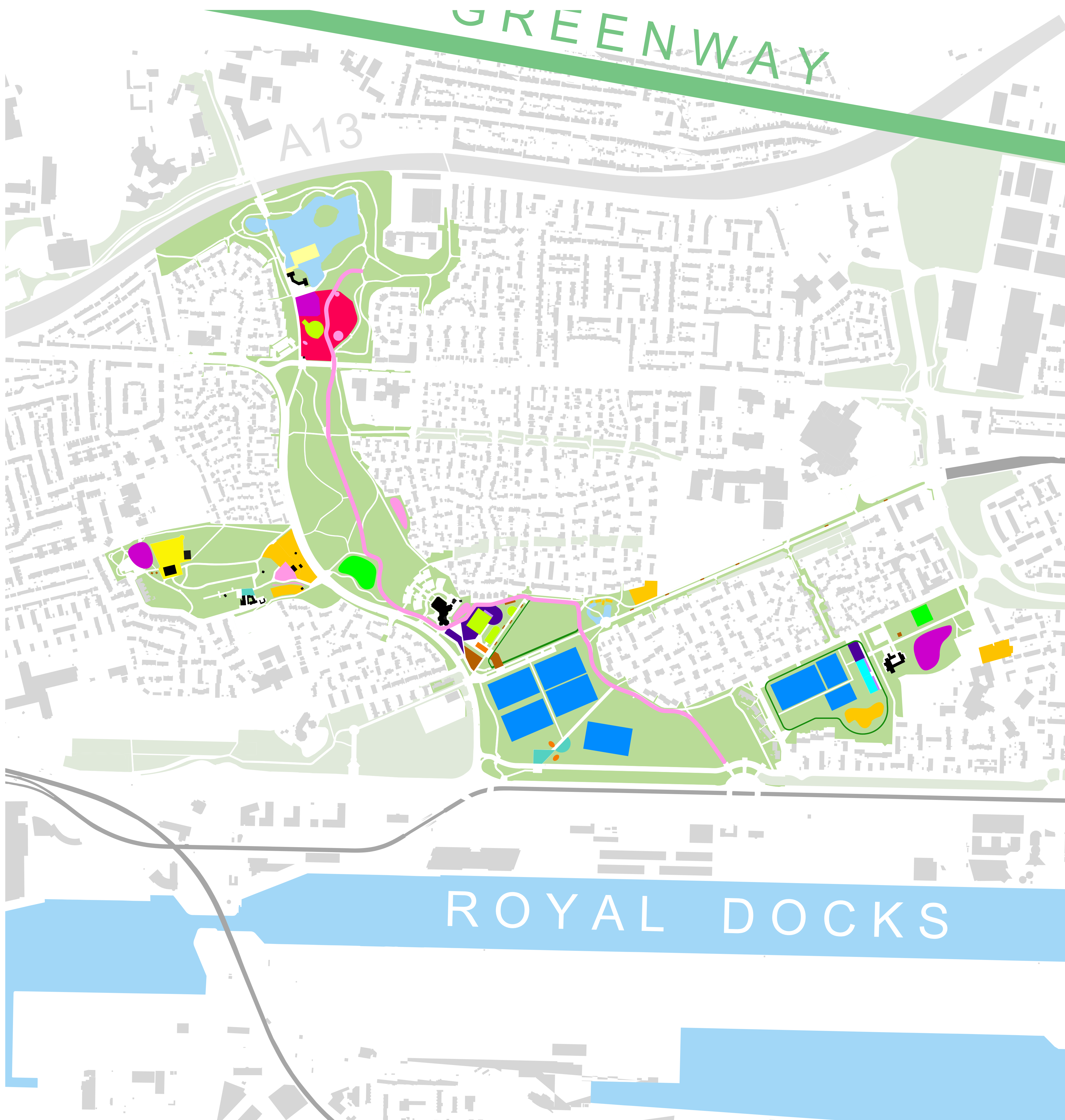

Masterplan overview of the Sports and Play strategy as per the Masterplan Vision.

The Community Vision for Sport, Leisure & Play



Vision of Will Thorne Pavillion Sports and Leisure Hub from the Masterplan.

The Masterplan Ingredient list back in 2022:
 Bouldering - Climbing - Running - Seating - Gym - Pathways - Urban Sports (wheels and parkour) - MUGA (football and basketball) - Cafe - Greening - Lighting - Trees - Children Play - SEND features - Toilets - CCTV - Entrances - Clean Spaces



The Masterplan ingredient list back in 2022.

Emerging Design Proposals

Turning Vision into Reality Now!

The Parks Service currently have an opportunity to work with the Football Foundation, to install a PlayZone MUGA and have also secured some capital funding that can be spent on:

- A new path, with lighting and seating, connecting Stansfeld Road to Andrewes Gardens along the existing 'desire line'.
- A new Urban Play & Sports area with bouldering and wheeled play

We've therefore re-organised the design to (1) prioritise those features, and (2) allow other aspects of the Vision to then be added seamlessly in future phases. The existing play area will be replaced as part of the future works.



Longer term: the full Sports and Leisure Hub
The rest of the Vision will be delivered in coming years as funding becomes available.

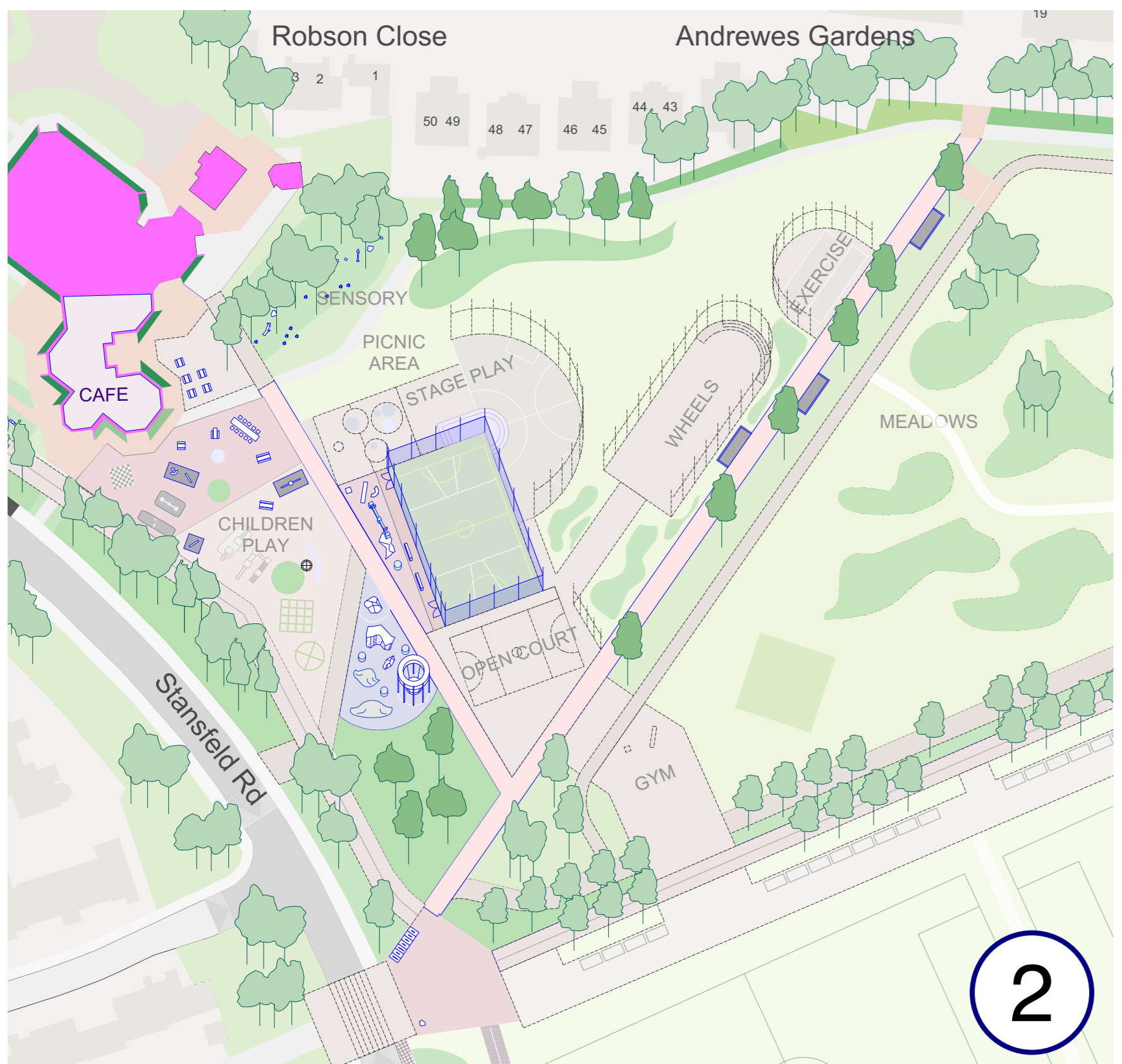

Longer term vision.



Detailed designs of the Phase 1 for the Urban Play and Sports currently being developed following the Masterplan Vision.

Getting the Details Right

Ingredients for Great Play, Sport and Leisure?

Please tells us what matters most to you...



Wheel Play



Scooter Play



Bouldering



Lighting



Playful seating

Look and feel images of what the designs could look like!



Informal seating



Greening



Playzone MUGA

Similar completed projects for inspiration!



Pathways

- Bouldering
- Climbing
- Running Tracks
- Seating
- Gym
- Pathways
- Urban Sports (wheels and parkour)
- MUGA football / basketball
- Play for younger children
- SEND accessibility

