

Notes:

1. All signs and cones to be accordance with Chapter 8-2009, the TSRGD and current IAN's.
2. Works access and egress are indicative, exact locations to agreed on site.
3. Safety zones are to be installed as required.
4. All signs to be located so as not to obscure signs or objects and should be ballasted near to ground.
5. Level using sand filled hessian bags or sign straps.
6. Drawings not to scale.
7. TM will comply with safety at Street Works and Road Works Code Of Practice 2013
8. All bus stops, Parking / loading bays to be suspended prior to works commencing.
9. All carriageway widths for running lanes through the site to be minimum of 3.5m unless otherwise stated.
10. Upon installation the traffic management meets the requirements.
11. Sideways Safety Zone 0.5m Min (S)
12. Longways Safety Zone 0.5m Min (L)

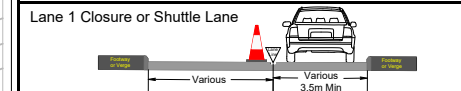

KEY

●●●●●	Traffic Cones	🚦	Traffic Signal
▲▲▲▲▲	No Waiting Cones	🚶	Pedestrian Signal
—	Pedestrian Barrier	👉	Pedestrian Ramp
▨	Works Area	Ⓚ	Bus Stop Suspended
→	Pedestrian Diversion	Ⓜ	Marshall Location
→	Diversion		

- Water Lane Closed Follow Diversion Via The Grove** x3
- Diversion for Keogh Road Follow Diversion Via Carnarvon Road** x1
- Diversion for Keogh Road Follow Diversion Via Carnarvon Road** x1

A	TMP	MM	14/01/26
REV:	DESCRIPTION:	BY:	DATE:

STATUS: **Approved**



CLIENT: **Newham London**

DESIGNER: **KENSON HIGHWAYS**
189 New Road
Rainham
RM13 8SH

TITLE: **Road Closure**

SITE: **Water Lane
London E15 4NL**



SCALE AT A3:	DATE:	DRAWN:	CHECKED:
NTS	14/01/2026	MM	SJ
PROJECT NO:	DRAWING NO:	REVISION:	
TBC	NH-750	A	